



FMC Corporation
Motor Coach Division
333 Brokaw Road Box 664 Santa Clara California 95052

☐ URGENT

☐ ROUTINE

☐ MANDATORY

☒ INFORMATIONAL

Service Bulletin

DATE September 30, 1974

NUMBER 2911-40002

ATTENTION: SERVICE MANAGERS AND OWNERS			GROUP
<u>INTRODUCTION</u> These instructions apply specifically to installation of a Cruise Control Kit for the 2900R Motor Home. Consult your FMC Motor Coach Division Dealer for availability and cost of installing this kit on your motor home.			11
			<u>SUBJECT</u> CRUISE CONTROL KIT #5101979-R020
<u>KIT CONTENTS</u>			<u>MODEL (S) AFFECTED</u>
<u>MCD NUMBER</u>	<u>DESCRIPTION</u>	<u>QTY</u>	2900R MOTOR HOMES SERIAL 00001 TO 00531
5101979-01	Regulator Assembly	1	
5101979-02	Screw and Washer (1/4-20 x 1/2)	2	(Factory Use Only) Information added to:
5101979-03	Servo-Vacuum	1	
5101979-04	Bracket-Servo Mounting	1	OWNER MANUAL (S)
5101979-05	Nut and Washer (1/4-20)	1	
5101979-06	Screw (3/8-16 x 1)	2	SERVICE MANUAL (S)
5101979-07	Washer, lock (3/8)	2	
5101979-08	Rod, Servo	1	PARTS MANUAL (S)
5101979-09	Retainer, Servo Rod	1	
5106949	Lever Assembly-Cruise Control/ Turn Signal	1	WARRANTY MANUAL (S)
5101138	Connector, Lever Wires	1	
5101979-R021	Harness, Regulator to Coach Wiring	1	OTHER
5101979-12	Cable, Regulator to Transmission	1	
5101979-13	Hose, Servo Vacuum (7/32 x 60")	1	
5101979-14	Tee, Servo Vacuum Hose	1	
5101979-15	Strap, Drive Cable	3	
5100311-01	Eye, Throttle Cable Terminal	1	
5100861	Bushing, Throttle Cable	1	
M16010	Wire, Stop Light Switch Ground (18 gauge, white)	20"	
M15031	Terminal, Ground Wire Slip On	1	
M15019	Terminal, Ground Wire Ring	1	
<u>INSTALLATION STEPS</u> 1. Disconnect negative battery cable from automotive battery at right rear of coach. 2. Remove steering wheel from column (See Service Manual, Group 7). 3. Install the Cruise Control-Turn Signal lever (5106949) in steering column.			



FMC Corporation
Motor Coach Division
333 Brokaw Road Box 664 Santa Clara California 95052

☐ URGENT

☐ ROUTINE

☐ MANDATORY

☒ INFORMATIONAL

Service Bulletin

DATE September 30, 1974

NUMBER 2911-40002

ATTENTION: SERVICE MANAGERS AND OWNERS	GROUP 11
4. Route lever wires inside black tubing on steering column. 5. Install connector (5101138) to lever wires (yellow, brown, red, green) to connect to existing connector under dash panel. NOTE Existing connector has four wires (white, white/black, black, and white/blue). See Figure 1 for connections.	SUBJECT CRUISE CONTROL KIT #5101979-R020
6. Install steering wheel (See Service Manual, Group 7). 7. At 15 pin connector under instrument panel, insert the existing white/blue wire to connect to the existing white/green wire in the connector. (See Figure 1.) 8. Connect existing blue wire (taped in harness under dash) to one of two open terminals on the stop light switch. 9. Add white ground wire (M16010), with terminal (M15031), and terminal (M15019) to make a ground from stop light switch to any convenient grounding point on coach frame. 10. Disconnect existing speedometer cable and sending units from transmission and at coach frame. 11. Install drive cable (5101979-12) to transmission and to regulator. (See Figure 2). 12. Install existing speedometer sending unit and Thermasan speed sensing switch on regulator. Discard existing cable used to drive speed sensing switch. (See Figure 2). 13. Locate regulator (5101979-01) with speedometer sending unit and Thermasan speed sensing switch attached, on frame. (See Figure 2). 14. Locate, mark, and drill two 9/32" diameter mounting holes to hold regulator to frame.	MODEL (S) AFFECTED 2900R MOTOR HOMES SERIAL 00001 TO 00531
	(Factory Use Only) Information added to: OWNER MANUAL (S)
	SERVICE MANUAL (S)
	PARTS MANUAL (S)
	WARRANTY MANUAL (S)
	OTHER



☐ URGENT

☐ ROUTINE

☐ MANDATORY

☒ INFORMATIONAL

Service Bulletin

DATE September 30, 1974

NUMBER 2911-40002

ATTENTION: SERVICE MANAGERS AND OWNERS

GROUP

11

SUBJECT

CRUISE
CONTROL
KIT
#5101979-R020

MODEL (S)
AFFECTED

2900R MOTOR
HOMES
SERIAL 00001 TO
00531

(Factory Use Only)
Information
added to:

OWNER MANUAL (S)

SERVICE MANUAL (S)

PARTS MANUAL (S)

WARRANTY MANUAL (S)

OTHER

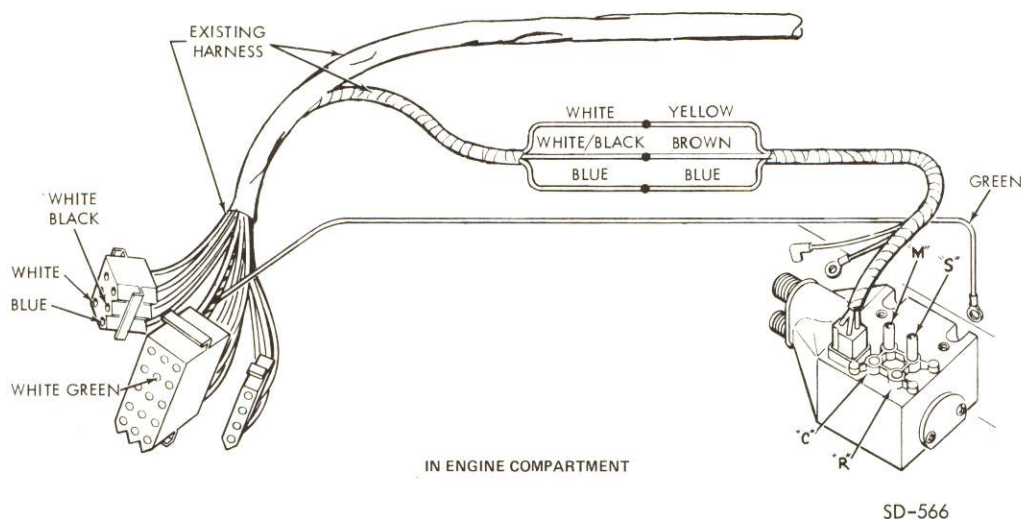
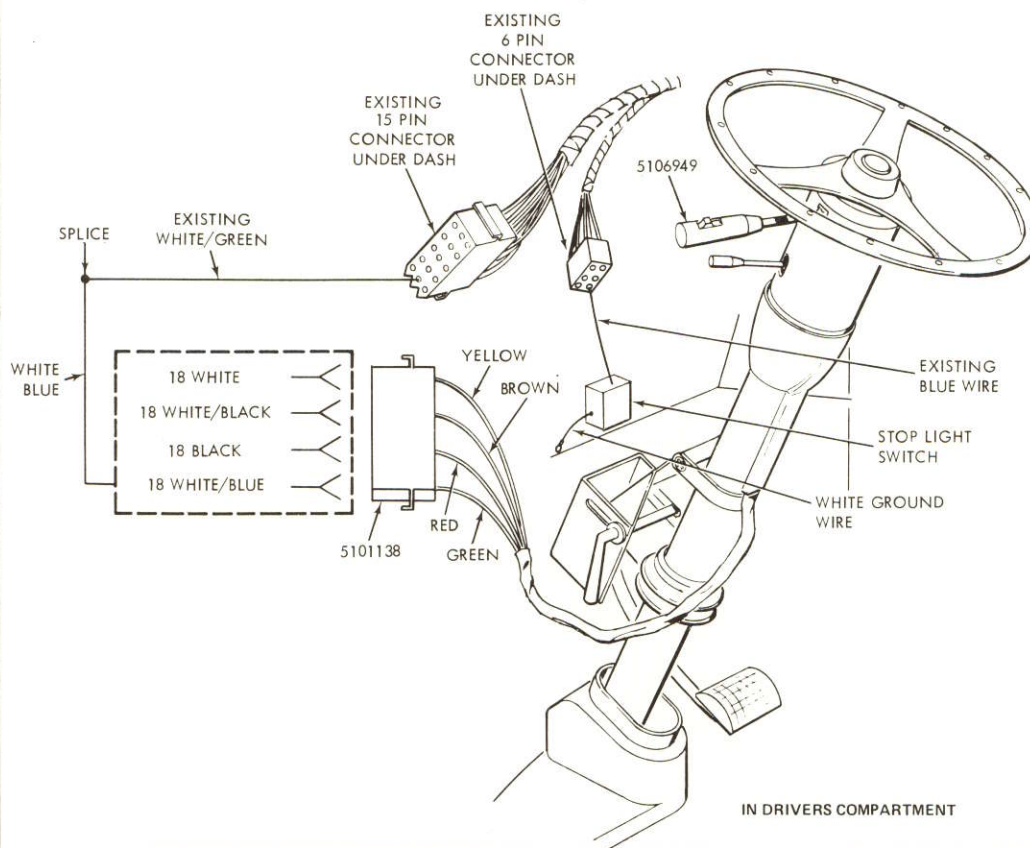

FIGURE 1. DRIVER'S AND ENGINE COMPARTMENTS HOOK UP



FMC Corporation
Motor Coach Division
333 Brokaw Road Box 664 Santa Clara California 95052

☐ URGENT

☐ ROUTINE

☐ MANDATORY

☒ INFORMATIONAL

Service Bulletin

DATE September 30, 1974

NUMBER 2911-40002

ATTENTION: SERVICE MANAGERS AND OWNERS	GROUP 11
<p style="text-align: center;">CAUTION</p> <p>Make certain you locate regulator so drive cable between transmission and regulator is not bent or kinked.</p> <p>15. Secure regulator to coach frame with two screws and washers (5101979-02). (See Figure 2).</p> <p>16. Remove air cleaner from carburetor. If coach is equipped with heavy duty air cleaner, remove air cleaner adapter from carburetor.</p> <p>17. Attach servo bracket (5101979-04) to the forward right head of the engine. Use existing holes in engine. Attach bracket with two screws (5101979-06) and washers (5101979-07).</p>	SUBJECT CRUISE CONTROL KIT #5101979-R020
<p style="text-align: center;">NOTE</p> <p>Do not use existing engine screws to secure bracket to engine.</p> <p>18. Attach servo (5101979-03) to mounting bracket with nut and washer (5101979-05).</p> <p>19. Attach servo rod (5101979-08) to throttle with retainer (5101979-09) and use existing throttle rod clip. Insert the straight end of servo rod through nylon bushing on servo.</p> <p>20. Remove existing eye fitting from end of throttle rod and replace with new ground parts 5100311-01, and bushing 5100861.</p> <p>21. With carburetor set on hot idle, install and adjust rod and retainer so that there is 1/16" clearance between retainer and face of nylon bushing on servo.</p>	MODEL (S) AFFECTED 2900R MOTOR HOMES SERIAL 00001 TO 00531
<p style="text-align: center;">NOTE</p> <p>Carburetor must be in hot idle position and off the fast idle cam.</p> <p>22. Attach vacuum hose (5101979-13) to servo hose connector, route to regulator unit, cut to length, and attach to "S" connector on regulator (Figure 1).</p>	(Factory Use Only) Information added to: OWNER MANUAL (S) SERVICE MANUAL (S) PARTS MANUAL (S) WARRANTY MANUAL (S) OTHER



FMC Corporation
Motor Coach Division
333 Brokaw Road Box 664 Santa Clara California 95052

☐ URGENT

☐ ROUTINE

☐ MANDATORY

☒ INFORMATIONAL

Service Bulletin

DATE September 30, 1974

NUMBER 2911-40002

ATTENTION: SERVICE MANAGERS AND OWNERS

GROUP

11

SUBJECT

CRUISE
CONTROL
KIT
#5101979-R020

MODEL (S)
AFFECTED

2900R MOTOR
HOMES
SERIAL 00001 TO
00531

(Factory Use Only)
Information
added to:

OWNER MANUAL (S)

SERVICE MANUAL (S)

PARTS MANUAL (S)

WARRANTY MANUAL (S)

OTHER

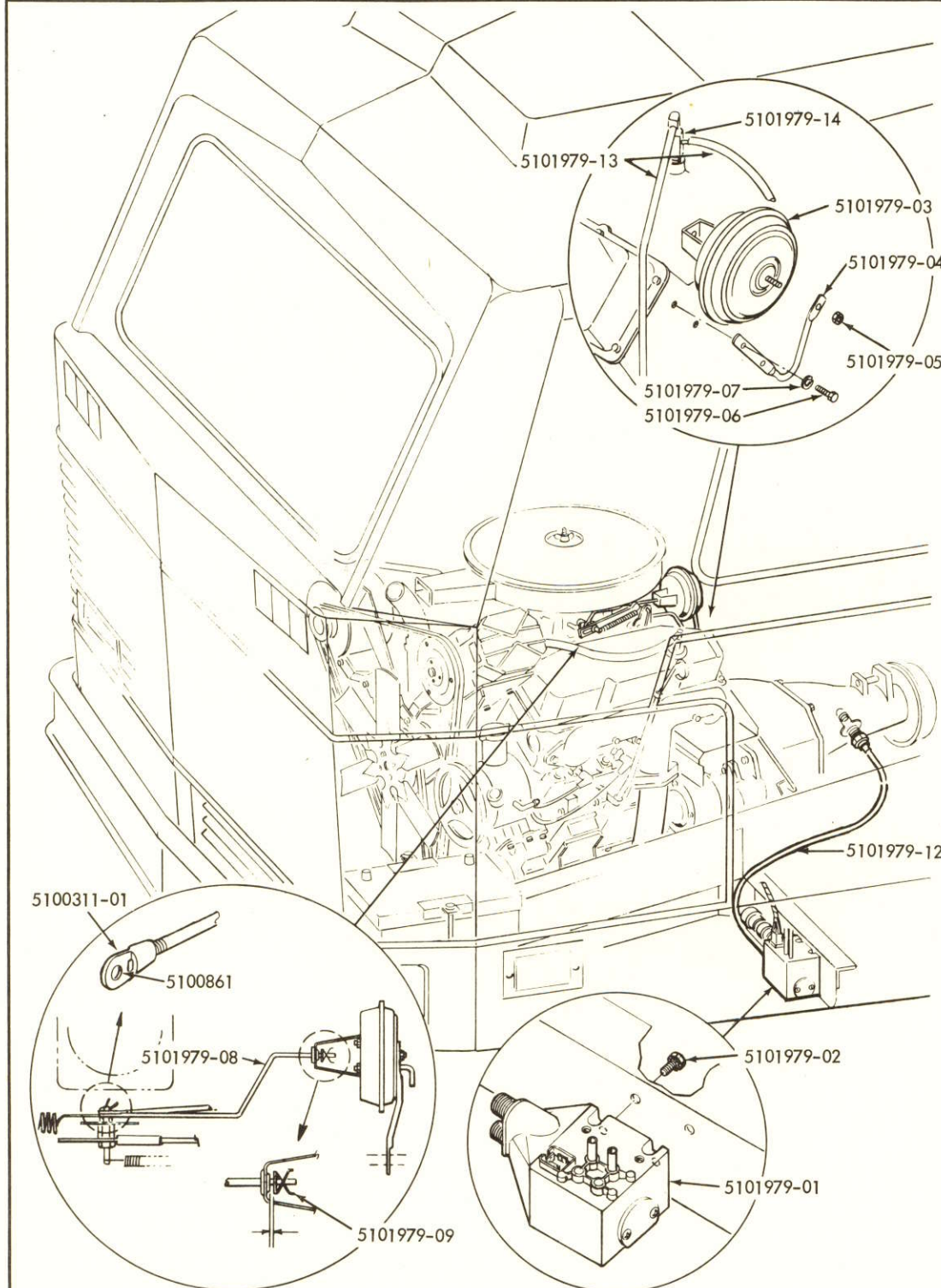

FIGURE 2. ENGINE COMPARTMENT



FMC Corporation
Motor Coach Division
333 Brokaw Road Box 664 Santa Clara California 95052

☐ URGENT

☐ ROUTINE

☐ MANDATORY

☒ INFORMATIONAL

Service Bulletin

DATE September 30, 1974

NUMBER 2911-40002

ATTENTION: SERVICE MANAGERS AND OWNERS	GROUP 11
23. Disconnect power brake line at intake manifold and remove hose adapter. 24. Install adapter tee (5101979-14) in intake manifold and reinstall hose adapter. 25. Install vacuum hose (5101979-13) on adapter tee and route to regulator. Cut to length and attach to "M" connector on regulator (Figure 1). 26. Install air cleaner or air cleaner adapter on carburetor.	SUBJECT CRUISE CONTROL KIT #5101979-R020
<p style="text-align: center;">CAUTION</p> <p>Make certain air cleaner or adapter clears the servo and servo rod and that there is no possibility of the linkage assembly becoming caught or entangled on any adjacent parts which could hold the throttle open. Work accelerator pedal several times to check.</p>	MODEL (S) AFFECTED 2900R MOTOR HOMES SERIAL 00001 TO 00531
27. Install harness 5101979-R021 on regulator. Attach three wire connector (yellow, blue, brown) to the three terminal connections on regulator. Attach connector (with green wire) to the threaded screw on regulator (See Figure 1).	(Factory Use Only) Information added to: OWNER MANUAL (S)
28. Strip covering from cut end of regulator harness. Disconnect the interface harness (under coach from front to rear) where it connects to engine harnesses (3 connectors) in rear compartment.	SERVICE MANUAL (S)
29. Wrapped within interface harness and taped together in a set of three (blue, black/white, and white) is a small harness to which the regulator harness is spliced.	PARTS MANUAL (S)
<p style="text-align: center;">NOTE</p> <p>It may be necessary to search under the coach to find this small harness. Some have been taped in the channel that carries the interface harness.</p>	WARRANTY MANUAL (S)
30. Splice "yellow" wire to existing "white" wire, "brown" wire to existing "white/black" wire, and "blue" wire to existing "blue" wire. Splice the "green" regulator harness wire into the "white/green" wire which is located in the 15 pin connector on the interface harness (See Figure 1.)	OTHER



☐ URGENT

☐ ROUTINE

☐ MANDATORY

☒ INFORMATIONAL

Service Bulletin

DATE September 30, 1974

NUMBER 2911-40002

ATTENTION: SERVICE MANAGERS AND OWNERS

GROUP

11

SUBJECT

CRUISE
CONTROL
KIT
#5101979-R020

MODEL (S)
AFFECTED

2900R MOTOR
HOMES
SERIAL 00001 TO
00531

(Factory Use Only)
Information
added to:

OWNER MANUAL (S)

SERVICE MANUAL (S)

PARTS MANUAL (S)

WARRANTY MANUAL (S)

OTHER

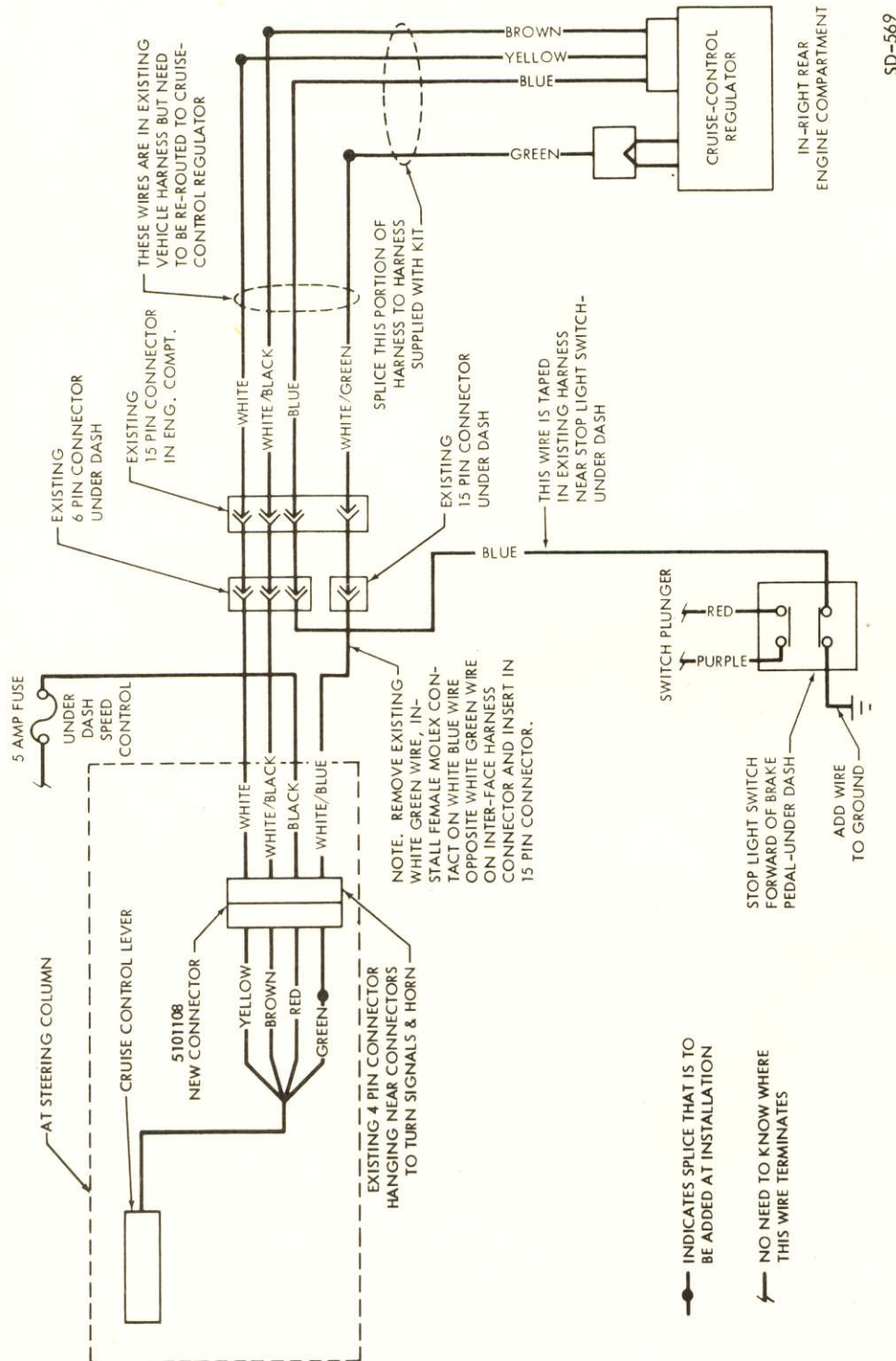

FIGURE 3. CRUISE CONTROL WIRING DIAGRAM



FMC Corporation
Motor Coach Division
333 Brokaw Road Box 664 Santa Clara California 95052

☐ URGENT

☐ ROUTINE

☐ MANDATORY

☒ INFORMATIONAL

Service Bulletin

DATE September 30, 1974

NUMBER 2911-40002

ATTENTION: SERVICE MANAGERS AND OWNERS

GROUP

11

SUBJECT

CRUISE
CONTROL
KIT
#5101979-R020

MODEL (S)
AFFECTED

2900R MOTOR
HOMES
SERIAL 00001 TO
00531

(Factory Use Only)
Information
added to:

OWNER MANUAL (S)

SERVICE MANUAL (S)

PARTS MANUAL (S)

WARRANTY MANUAL (S)

OTHER

SWITCH OPERATION DATA

	SLIDE SWITCH			SET SPEED BUTTON DEPRESSED AND SLIDE SWITCH ON
	OFF	ON	RES.	
RED/BROWN	OPEN	CLOSED	CLOSED	CLOSED
RED/GREEN	OPEN	CLOSED	CLOSED	OPEN
RED/YELLOW	OPEN	OPEN	CLOSED	CLOSED

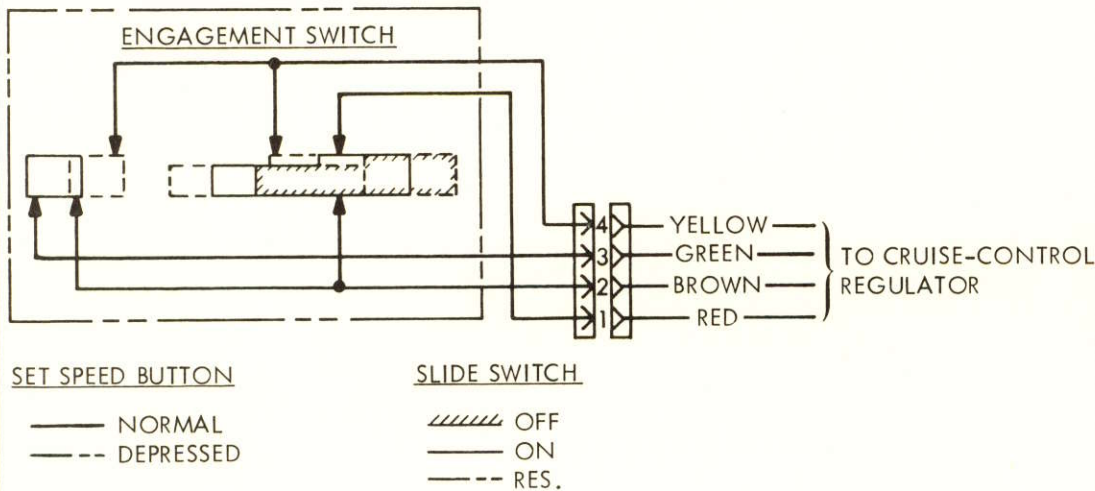

SD-568

FIGURE 4.. CRUISE CONTROL SWITCH



FMC Corporation
Motor Coach Division
333 Brokaw Road Box 664 Santa Clara California 95052

☐ URGENT

☐ ROUTINE

☐ MANDATORY

☒ INFORMATIONAL

Service Bulletin

DATE September 30, 1974

NUMBER 2911-40002

ATTENTION: SERVICE MANAGERS AND OWNERS

GROUP

11

31. Check all wiring connections per Figure 3.

32. Reconnect automotive battery and check operation of cruise control buttons on lever. See Figure 4 for proper operation and positions.

33. Road test system before delivering coach to customer.

SUBJECT

CRUISE
CONTROL
KIT

#5101979-R020

MODEL (S)
AFFECTED

2900R MOTOR
HOMES
SERIAL 00001 TO
00531

Max Snavely
Max Snavely
Service Manager

(Factory Use Only)
Information
added to:

OWNER MANUAL (S)

SERVICE MANUAL (S)

PARTS MANUAL (S)

WARRANTY MANUAL (S)

OTHER